

SPECIFICATIONS

DESCRIPTION:

Powerful adjustable accent LED light. Suitable for wet/damp/dry location installations.

MATERIAL:

Standard overall material is 6061 aluminum.
HL-915 - Machined Aluminum

FINISH:

- AA** - Anodized Satin Aluminum
- AP** - Powder Coat Aluminum
- BK** - Powder Coat Black
- BZ** - Powder Coat Bronze
- WT** - Powder Coat White

LAMPING:

Lamp Type - 3xLED, two wattages available.

- 5** - 5W
- 15** - 15W

CCT - Color Corrected Temperature

- 27** - 2700K, 5W/15W
- 35** - 3500K, 5W/15W
- 42** - 4200K, 5W
- 45** - 4500K, 15W
- 63** - 6300K, 5W

Optics - Four beam angles available.

- SP** - 10° Spot, 5W
- NF** - 20° Narrow Flood, 5W/15W
- FL** - 40° Flood, 5W/15W
- WFL** - 60° Wide Flood, 15W

VOLTAGE:

12 - 12-24 VAC output transformer required, not included.

MOUNTING:

Fixture is designed with a 1/2" NPS adjustable mounting stem.

OPTIONS:

Glare shields

GL-915 - Angled, aluminum

Lenses/Louvers/Color Filters

LA-1-20 - Hexcell Louver (Black)

LA-2-20 - Prismatic lens

LA-3-20 - Linear spread lens

LA-4-20 - Soft focus lens (diffused)

LA-5-20 - Moonlight lens

LA-6-20 - Blue lens

See fixture accessories for more information.

SAMPLE ORDER SPECIFICATION:

HL-915-5-35-20-12-GL-915-LA-1-20

RATING:

Wet/damp/dry location.



MADE IN THE USA

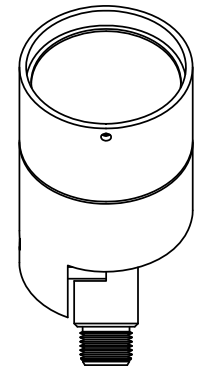
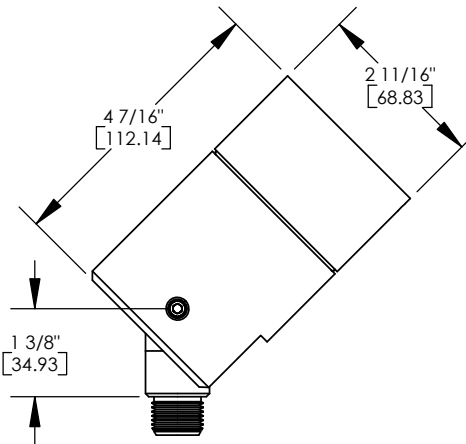

ORDER SPECIFICATION: _____ - _____ - _____ - _____ - _____
 Fixture - Finish - W-CCT-Optics - Voltage - Options/Access.

PROJECT:

APPROVED:

NOTE:

TYPE:

Master Canadian Distributor:



Web: www.spectralv.ca | Ph: 905-751-8490 | Fx: 905-836-6772